

Just over Hub between tracks on 28th of Sta
 page 45 (this book) for Intersection, thence
 10° offset North 28th St (produced 1/2 of 90° S.E.
 of 30th St thence set Hub 0 either side
 90° S. + mark + set Hub distant 10° for Center
 P.S. on Hub 10' South of 30th St + C. of Sinesse a.
 of East rail. thence Just over later Hub
 Hub on U.P. Embankment about 5° East
 of Mt 37 Double Centered, set
 Sinesse on P.S. on Hub 10° S with
 of a line 30th St on Center line
 thence Just over Hub on 10' offset S with
 set Hub 10° South of Mt 37 for P.S.
 Cutting heavy timber.
 Hub 10° for offset line to avoid
 wash an) 90° 00' S + South and set
 Intersection) P.S. on Mt 07 (20th
 and 30th St (previously established by
 Just over Hub Center Sinesse are
 (Center line 30th St continued from Page 45)
 Wednesday P.M. Jan 29th 1890

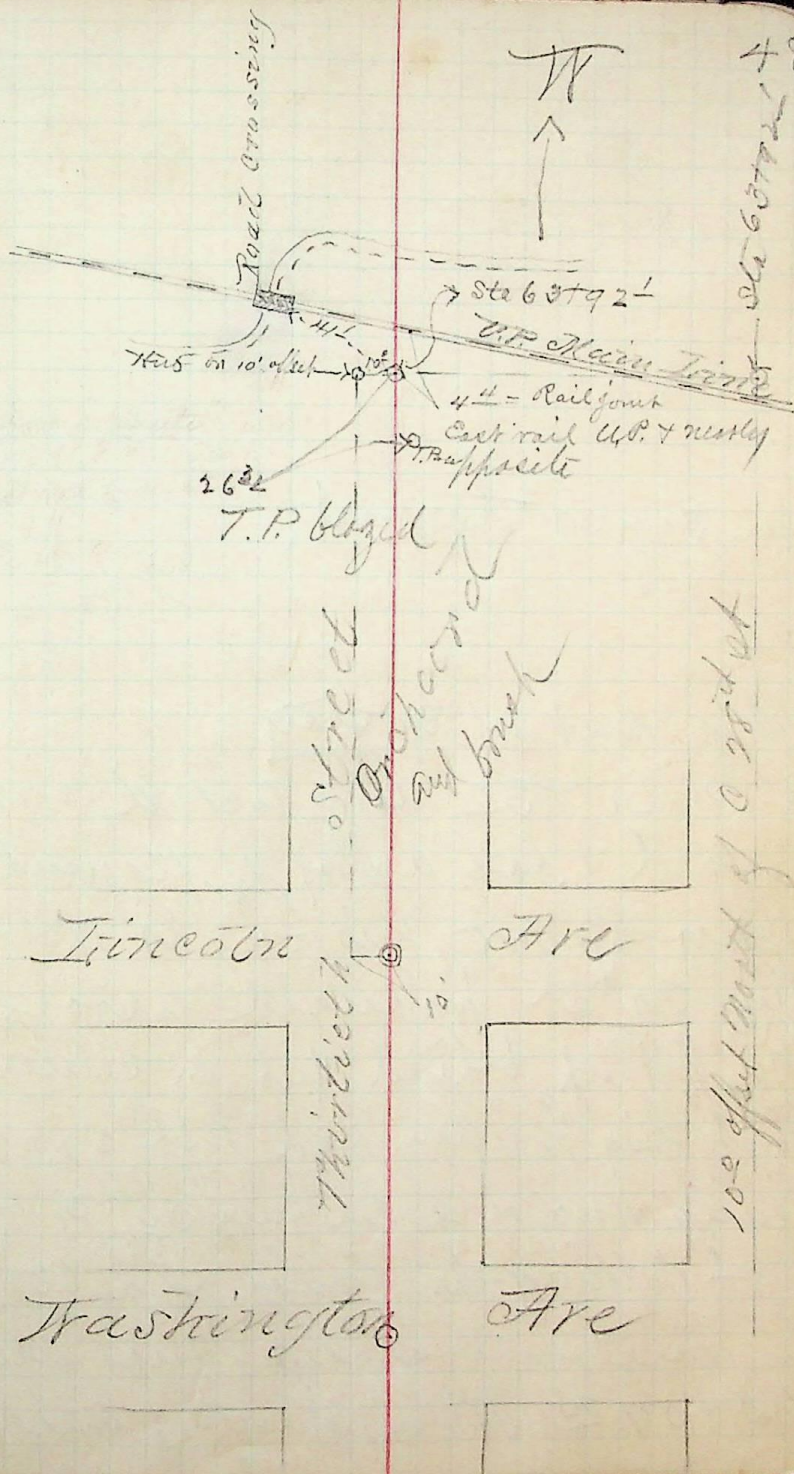

48

100' offset West of 30th St